

TOPPING<sup>TM</sup>

*D30*  
User's Manual

# Introducing

Dear Users :

Thank you for purchasing TOPPING's high resolution DAC D30! D30 is designed for high resolution desktop hifi, we hope you can enjoy and love it.

Please read this manual before you use D30.

## Introducing

D30 is a high performance DAC with USB, Coaxial and Optical input.  
USB support 16bit-24bit/32-192kHz PCM input and DSD64, DSD128 input.  
Coaxial and Optical support 16bit-24bit/32-192kHz S/PDIF input.

## Spec

USB input	Up to 24bit/192kHz, DSD128
Coaxial, Optical input	Up to 24bit/192kHz
Power input	DC15V,1A
Dimensions	122mm X 38mm X 177mm
Weight	427g
Accessories	D30 X 1, AC adapter X1, USB cable X 1,Warranty Card X1, USB disk(Drivers and Tutorial) X1

## Spec

Line out voltage	2.1Vrms
THD+N*	0.0006@0dBFs 1KHz
Noise*	3.8u Vrms
SNR*	115dB
Crosstalk	-125dB@1KHz

\*A-Weighted

## Components guide



- ① Power switch
- ② Input selector switch
- ③ Power LED
- ④ Unlock LED. It will turn on if input signal is invalid or abnormal.  
It go off if input signal is OK.

## Components guide

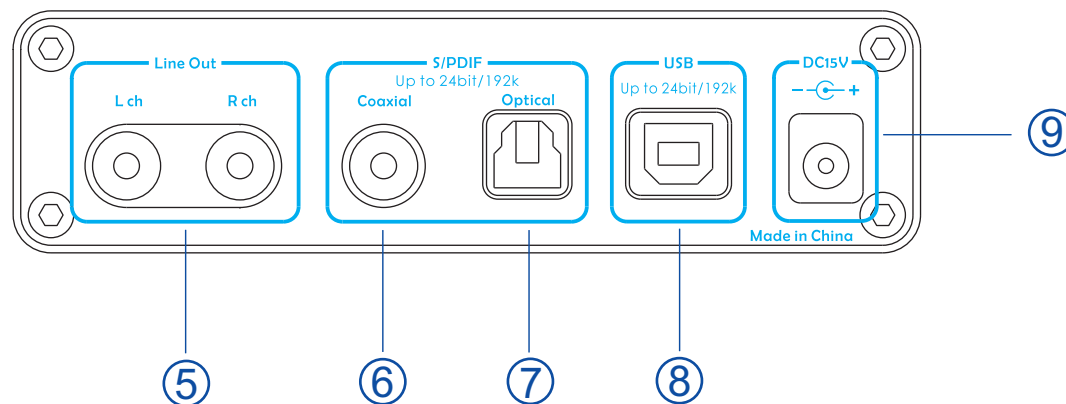

- ⑤ Line Out. Connect to an amplifier or other device.
- ⑥ Coaxial input. Support PCM format, 16-24bit/32kHz-192kHz S/PDIF input.
- ⑦ Optical input. Support PCM format, 16-24bit/32kHz-192kHz S/PDIF input.
- ⑧ USB input. Support PCM format, 16-24bit/32kHz-192kHz input, and DSD64, DSD128 input.
- ⑨ Power input.

# Operate

## Coaxial and Optical DAC:

1. Connect Coaxial or Optical signal from your player to D30 as below.
2. Turn on D30 and select to the input you connected, check Unlock LED to judge signal is OK or abnormal.
3. Connect Line out to amplifier or other device you need.
4. Play music at the device which output Coaxial or Optical signal.

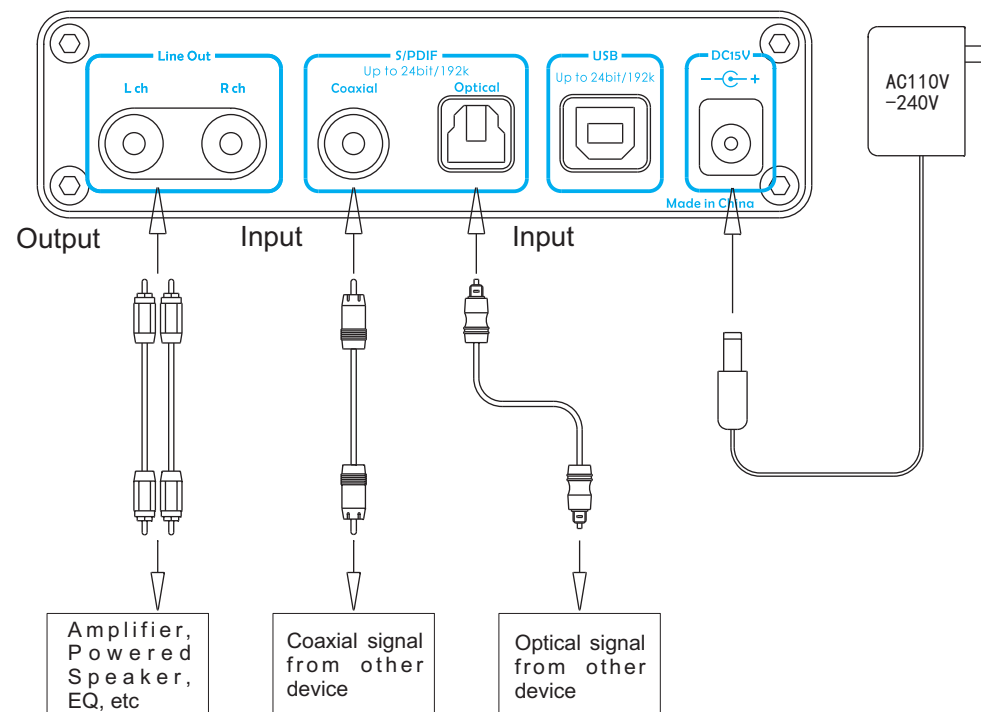



# Operate

## USB DAC:

1. Connect D30 to your PC as below.
2. Turn on D30 and select to USB input (You need to install driver of D30 at the first time you use on Window OS, you can find the tutorial in this USB disk. Mac OS X 10.6.4 and higher version needn't a driver). Check Unlock LED to judge signal is OK or abnormal.
3. Connect Line out to amplifier or other device you need.
4. Play music at your computer. (You can find the tutorial of setting a Foobar2000 player or a JRiver player in this USB disk)

You can connect D30's USB to some mobile phone, you can find the tutorial in this USB disk.

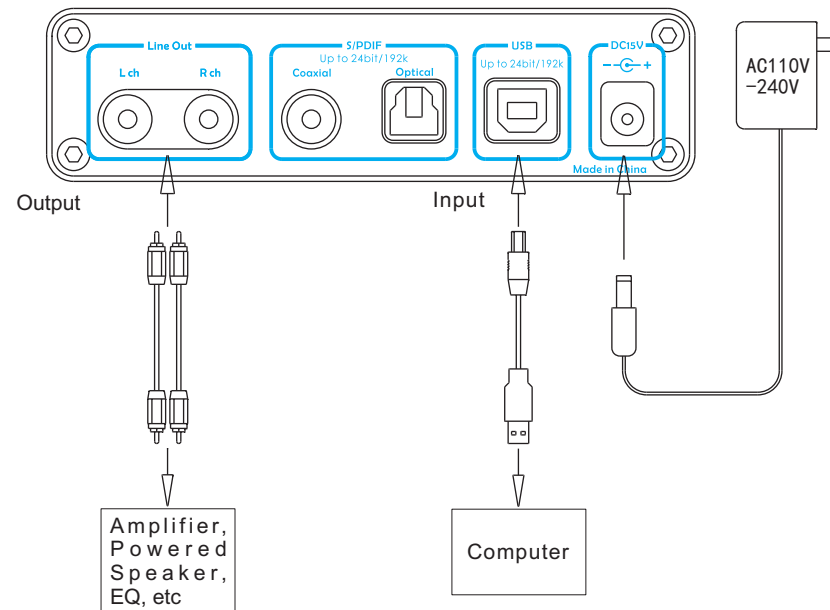

# AP test result

Audio Precision

A-A THD+N vs FREQUENCY

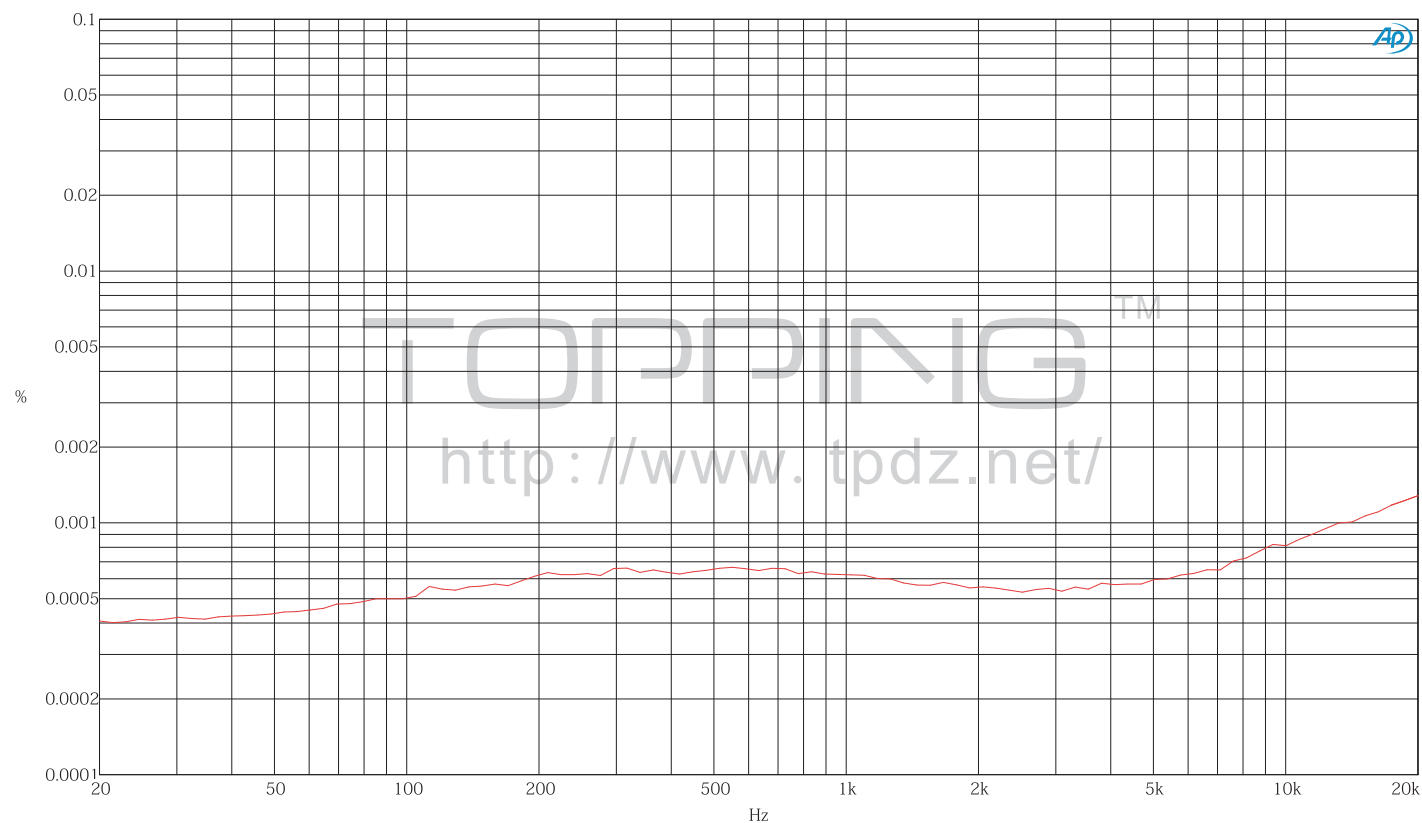

Sweep	Trace	Color	Line Style	Thick	Data	Axis	Comment
1	1	Red	Solid	5	Analyzer:THD+N Ratio A	Left	D30 THD+N vs FREQ @96K OdBFs

D30 COAX THD+N vs FREQ @96K OdBFs.ats2

# AP test result

Audio Precision

Frequency Response

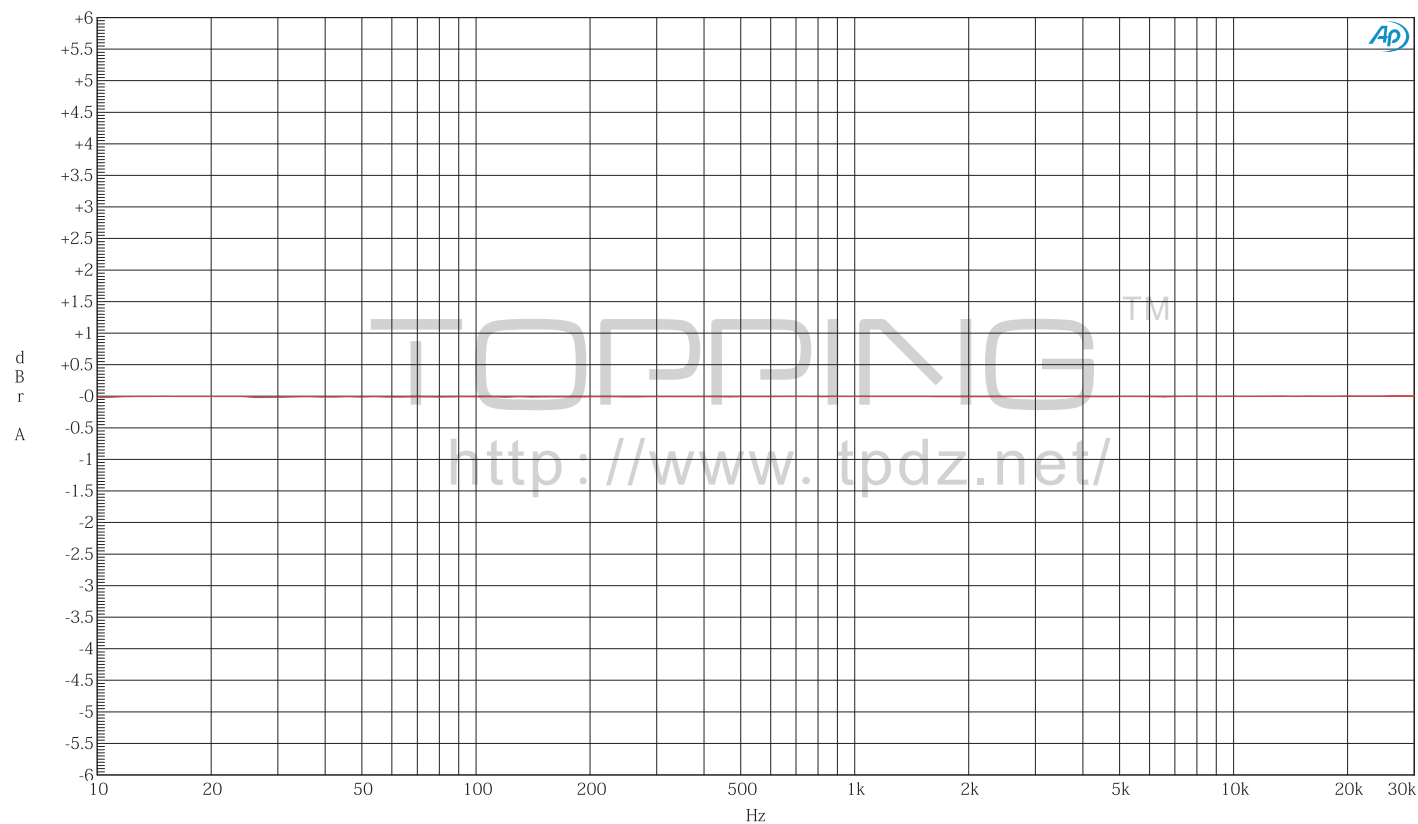

Sweep	Trace	Color	Line Style	Thick	Data	Axis	Comment
1	1	Red	Solid	5	Analyzer.Level A	Left	D30 Frequency Response

D30 COAX FREQ RESP @96K OdBFs.ats2

# AP test result

Audio Precision

THD+N vs LEVEL

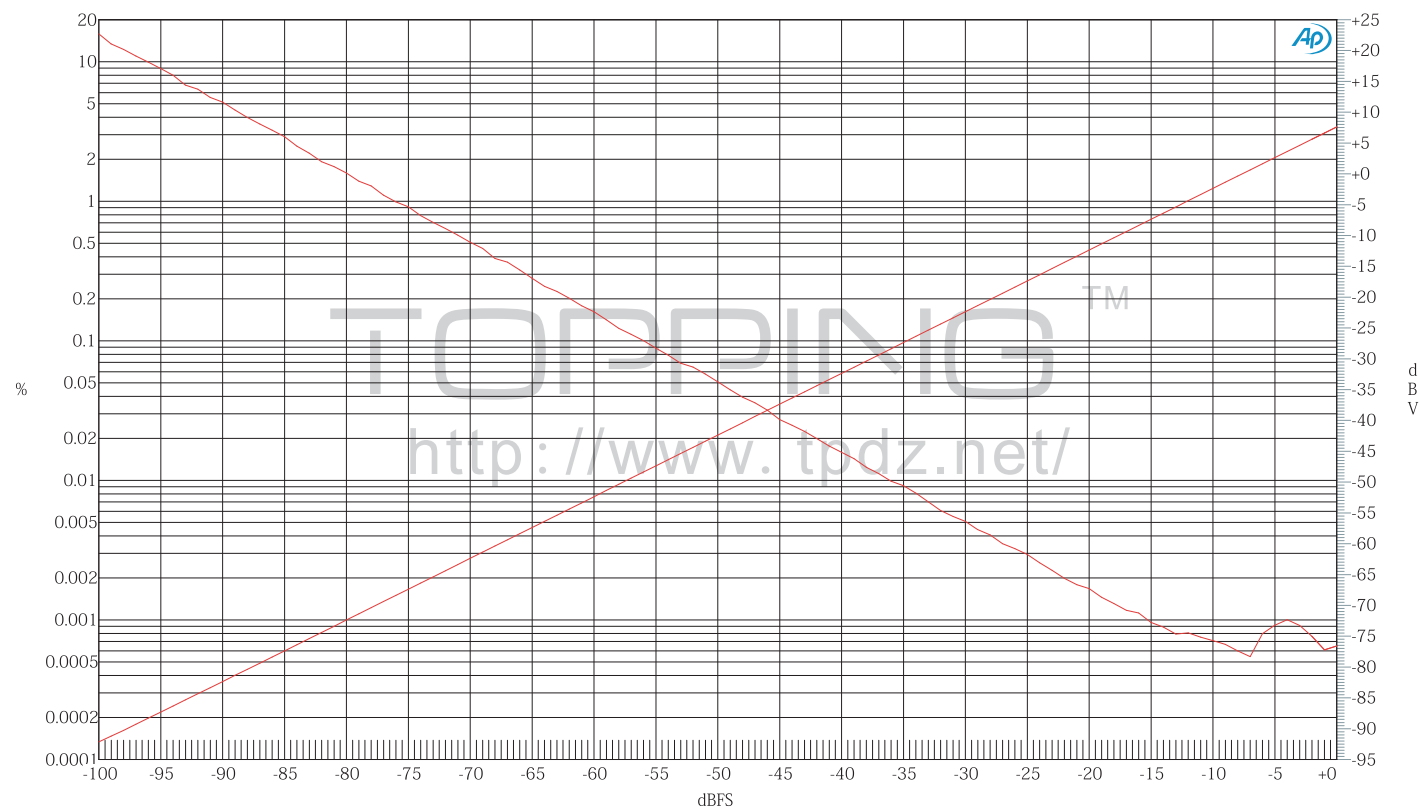

Sweep	Trace	Color	Line Style	Thick	Data	Axis	Comment
1	1	Red	Solid	5	Analyzer:THD+N Ratio A	Left	
1	2	Red	Solid	5	Analyzer:Level A	Right	

D30 THD+N vs LEVEL @96K.ats2

# AP test result

Audio Precision

1K FFT @ OdBFs

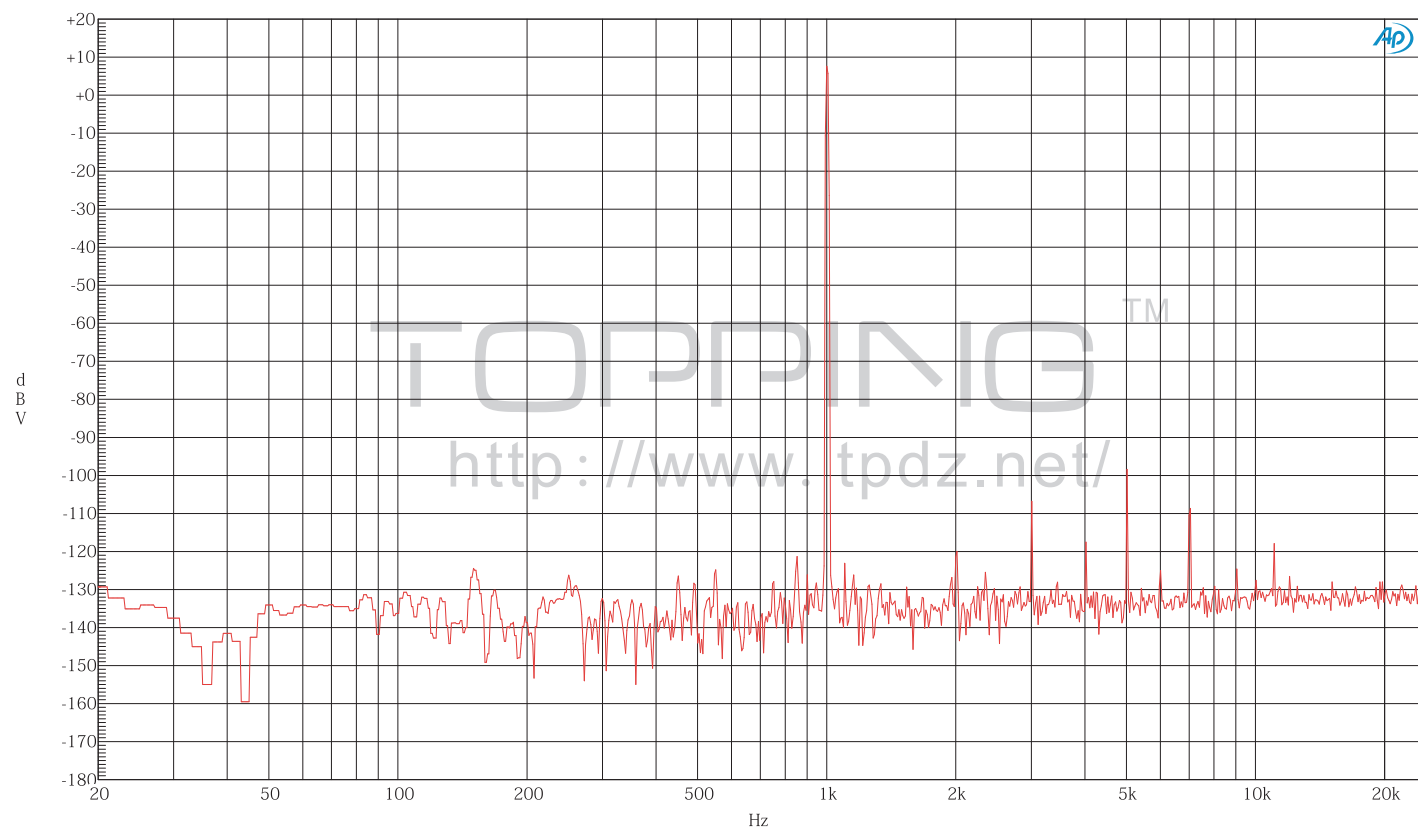

Sweep	Trace	Color	Line Style	Thick	Data	Axis	Comment
1	1	Red	Solid	5	FFT.ChA Amplitude	Left	D30 COAX 1K FFT @ OdBFs 96K

D30 COAX 1K FFT @ OdBFs 96K.ats2

# AP test result

Audio Precision

1K FFT @ -60dBfs

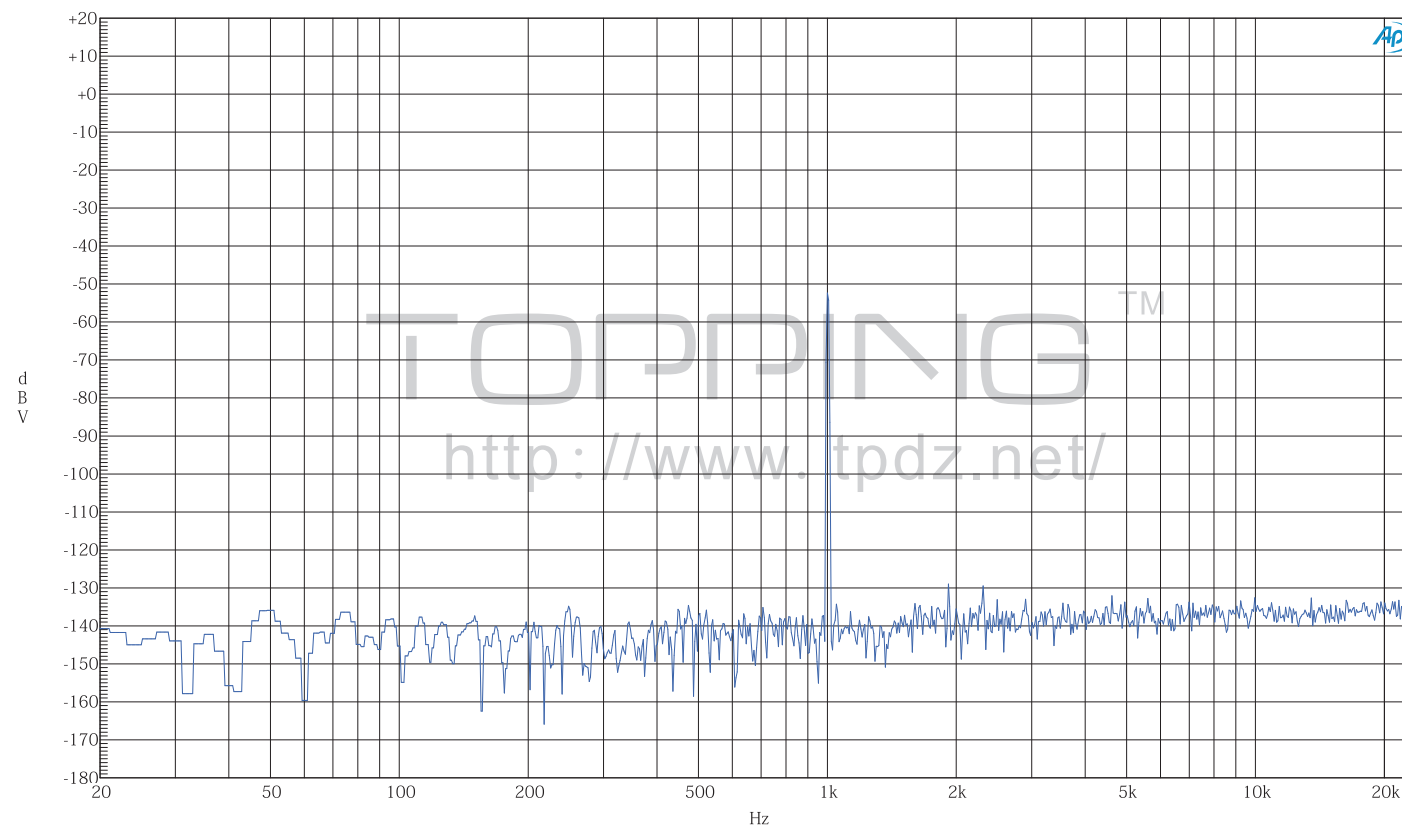

Sweep	Trace	Color	Line Style	Thick	Data	Axis	Comment
2	1	Blue	Solid	5	FFT.ChA Amplitude	Left	D30 COAX 1K FFT @ -60dBfs 96K

D30 COAX 1K FFT @ -60dBfs 96K.ats2

# AP test result

Audio Precision

Crosstalk

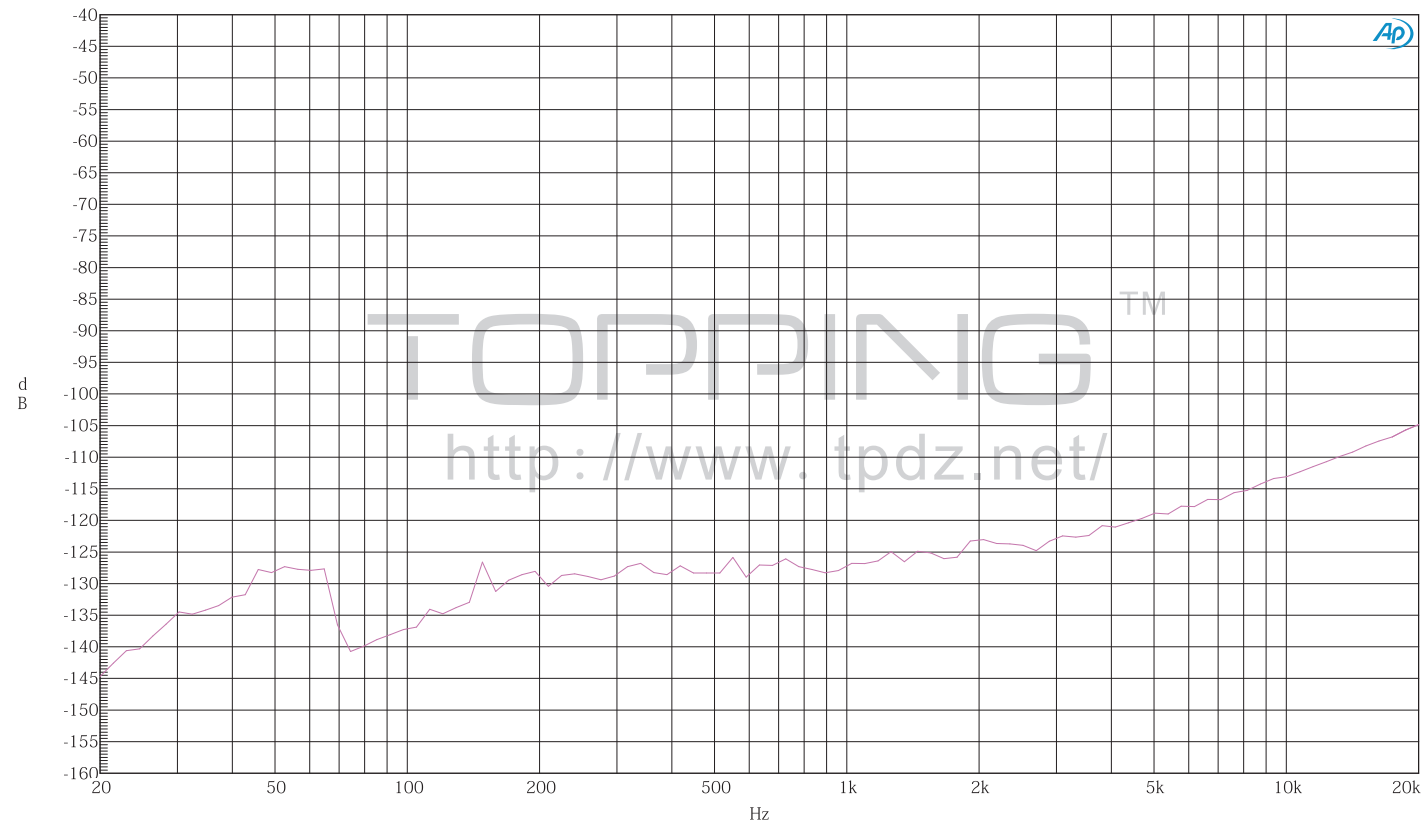

Sweep	Trace	Color	Line Style	Thick	Data	Axis	Comment
1	2	Magenta	Solid	5	Analyzer:Crosstalk B	Left	D30 Crosstalk @96K 0dBfs

D30 Crosstalk @96K 0dBfs.ats2

## Precautions for daily use

- ① Never pull out the USB cable while connected to a computer and using the audio output.
- ② Ensure the output jack, could not short circuit or connect to ground.
- ③ You must not keep the amplifier in a hot, humid environment or drop it.
- ④ Opening the case instantly voids the warranty!
- ⑤ Use only the specified AC adapter.
- ⑥ Indoor use only.



# Troubleshooting

Problem	Probably is...	solution
Can not boot	No power input	Check power input
Unlock	Unknown signal format	Change to correct format
	Signal cable loose	Check signal cable
	No signal input	Check the player
Noise at Coaxial or Optical input	Wrong format of input signal or signal out of support range	Check input signal
Unknown USB device	USB cable loose	Check USB cable
	PC's USB port damage	Change another USB port
	OS problem	Reinstall OS
	Driver problem	Reinstall driver
No sound at USB input	Too low volume at PC	Adjust volume of PC
Intermittent sound at USB input	PC too busy that D30 was hung up	Wait for it
Pop sound at USB input	Software problem	Update motherboard driver and OS

## About the weak current feel on the aluminum case

In some very special case, some people could feel very weak current on the aluminum case.

The reason for this phenomenon is due to the electromagnetic interference suppression component in AC adapter, which built a necessary circuit between the primary and secondary.

This weak current is controlled within the limits of security standards required of, and the production of this product in the factory have passed the strict quality inspection, so you can feel free to use it.

TOPPING<sup>TM</sup>

address: 26th Jiaomen Road, Huangge Town,  
Nansha District, Guangzhou, China.

Tel : +86-020-37219489  
Fax : +86-020-37219489  
<http://www.tpdz.net/>